

Polias de Desvio (Padrão)

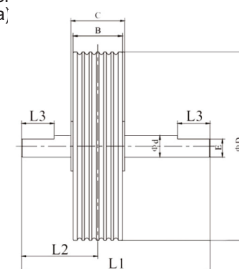
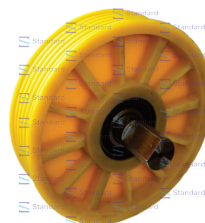
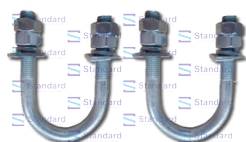

MODELO EM AÇO	Canais (Qtd.)	Tipo	Cabo Ø (mm)	Passo	Diâmetro (D)	Largura (B)	Largura Final (C)	Diâmetro (d)	Altura (E)	L1	L2	L3
DSV-240-6U8-IS	6	U	8	12	240	92	92	60	50	400	200	85
DSV-240-7U6-IS	7	U	6	12	240	102	102	60	50	400	200	85
DSV-320-6U8-IS	6	U	8	12	320	92	92	60	50	400	200	85
DSV-320-8U8-IS	8	U	8	12	320	92	92	60	50	400	200	85
DSV-400-6U10-IS	6	U	10	16	400	110	110	60	50	400	200	85
DSV-400-7U10-IS	7	U	10	14	400	114	110	60	50	400	200	85
DSV-400-8U10-IS	8	U	10	16	400	140	110	60	50	400	200	85
DSV-480-4U12-IS	4	U	12	18	480	84	84	60	50	400	200	85
DSV-520-6U13-IS	6	U	13	20	520	130	130	60	50	400	200	85
DSV-520-8U13-IS	8	U	13	20	520	173	173	80	65	400	200	85
DSV-640-8U16-IS	8	U	16	25	640	211	211	90	80	400	200	85

MODELO EM NYLON	Canais (Qtd.)	Tipo	Cabo Ø (mm)	Passo	Diâmetro (D)	Largura (B)	Largura Final (C)	Diâmetro (d)	Altura (E)	L1	L2	L3
DSV-240-6C8-12-NY	6	U	8	12	240	92	92	60	50	300	150	85
DSV-240-7C6-12-NY	7	U	6	12	240	102	102	60	50	300	150	85
DSV-320-6C8-12-NY	6	U	8	12	320	92	95	60	50	300	150	85
DSV-400-6C10-16-NY	6	U	10	16	400	105	105	60	50	300	150	85

Amortecedor para Base de Máquina

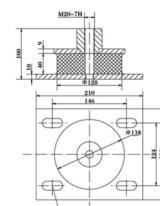

MODELO	CARGA MÁXIMA (Kg)	DUREZA	DEFORMAÇÃO	CAPACIDADE DE AMORTECIMENTO
RBISN-A	6000	Hs70±5	2mm/1200Kg	>25Kg/cm²